

Features

- ESD / transient protection of high speed data lines
 - IEC 61000-4-2 (ESD): $\pm 30\text{kV}$ (air), $\pm 30\text{kV}$ (contact)
- Working voltage: $V_{RWM} = 15\text{V}$
- Very Low Leakage current
- Very low load capacitance
- RoHS compliant with Halogen-free

HF

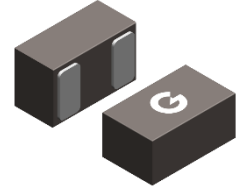

DFN1006-2

Mechanical Data

- Case: DFN1006-2
- Molding Compound: UL Flammability Classification Rating 94V-0
- Terminals: Matte tin-plated leads; solderability-per MIL-STD-202, Method 208

Ordering Information

Part Number	Package	Shipping Quantity	Marking Code
GESD15VBL	DFN1006-2	10000 pcs / Tape & Reel	N15

Maximum Ratings (@ $T_A = 25^\circ\text{C}$ unless otherwise specified)

Parameter	Symbol	Value	Unit
IEC 61000-4-2; ESD (Air)	V_{ESD-A}	± 30	kV
IEC 61000-4-2; ESD (Contact)	V_{ESD-C}	± 30	kV
Peak Pulse Power ($t_p = 8/20\mu\text{s}$)	P_{PP}	160	W
Peak Pulse Current ($t_p = 8/20\mu\text{s}$)	I_{PP}	5	A

Thermal Characteristics

Parameter	Symbol	Value	Unit
Junction Temperature Range	T_J	$-55 \sim +125$	$^\circ\text{C}$
Storage Temperature Range	T_{STG}	$-55 \sim +150$	$^\circ\text{C}$

Electrical Characteristics (@ $T_A = 25^\circ\text{C}$ unless otherwise specified)

Parameter	Symbol	Test Condition	Min.	Typ.	Max.	Unit
Reverse Stand-off Voltage	V_{RWM}		-	-	15	V
Reverse Breakdown Voltage	$V_{(BR)}$	$I_T = 1\text{mA}$	16.7	-	-	V
Reverse Leakage Current	I_R	$V_{RWM} = 15\text{V}$	-	-	1	μA
Clamping Voltage	V_C	$I_{PP} = 1\text{A}, t_p = 8/20\mu\text{s}$	-	-	23	V
		$I_{PP} = 5\text{A}, t_p = 8/20\mu\text{s}$	-	-	32	V
Junction Capacitance	C_J	$V_R = 0\text{V}, f = 1\text{MHz}$	-	15	45	pF

Ratings and Characteristic Curves (@ $T_A = 25^\circ\text{C}$ unless otherwise specified)

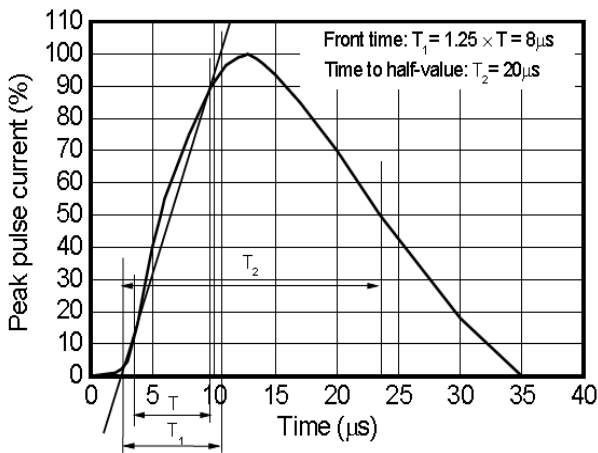

Fig 1 8/2 0µs waveform per IEC61000-4-5

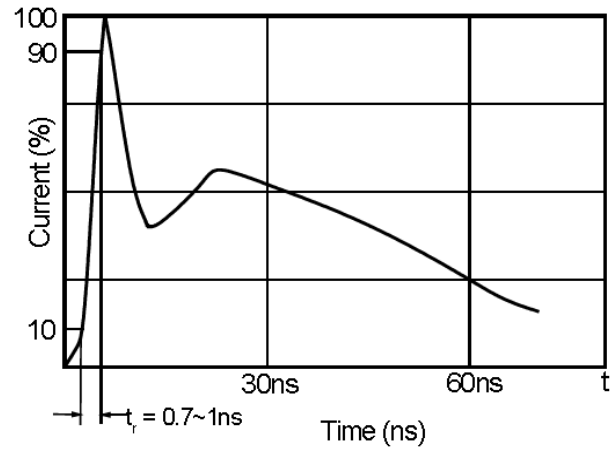

Fig 2 ESD pulse waveform according to IEC61000-4-2

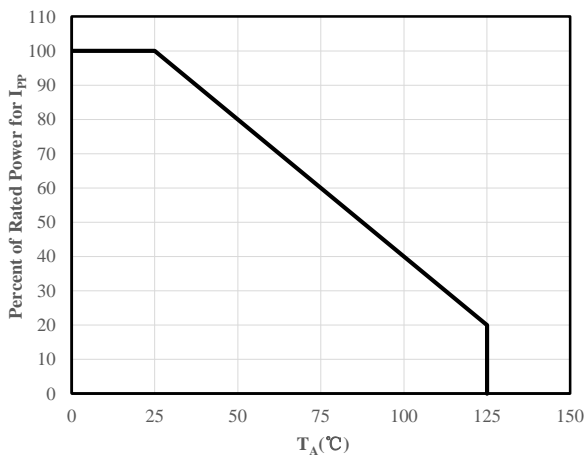

Fig 3 Power Derating Curve

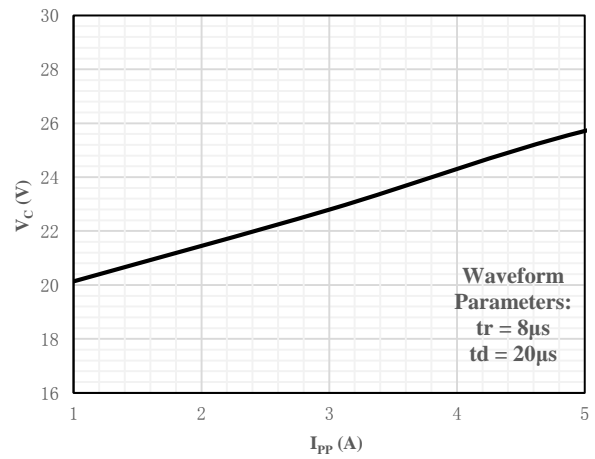

Fig 4 Clamping Voltage vs. Peak Pulse Current

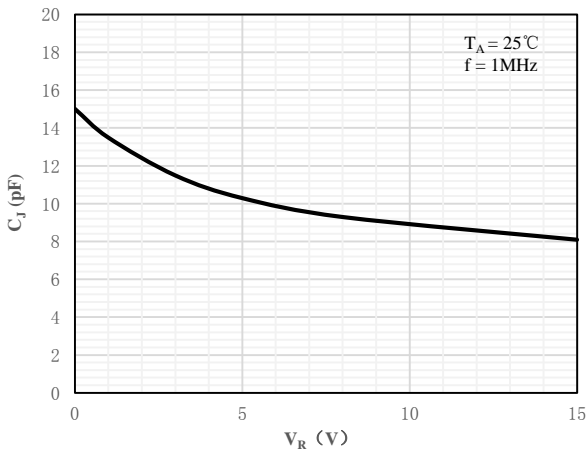
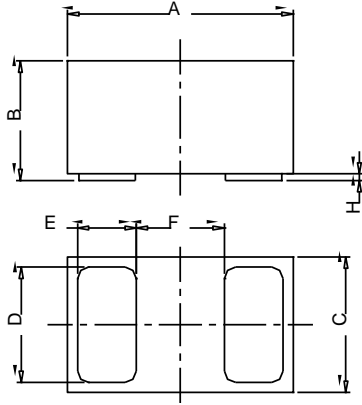

Fig 5 Capacitance vs. Reverse Voltage

Package Outline Dimensions (Unit: mm)



DFN1006-2			
Dimension	Min.	Typ.	Max.
A	0.95	1.00	1.075
B	0.47	0.50	0.53
C	0.55	0.60	0.675
D	0.45	0.50	0.55
E	0.20	0.25	0.30
F	-	0.40	-
H	0	0.03	0.05

Package Outline Dimensions (Unit: mm)

DFN1006-2

